

The SLX™ Searchlight module are created to push limits and maximize the potential in LED technology and optical performance.

Luminell SLX™ 220W LED Searchlight.
Distance: 257 meters.



«This is a perfect light for us! Regarding light beam, power and range there is nothing to complain about! The light always works and it gets a lot of beating in the rough Northern-Sea, with our small vessel traveling at 30 knots.»

Asbjørn Thomassen, RS-138 (Search and rescue Vessel)



Key Features

- Instant light
- No maintenance
- Upgrade your searchlight w./ different bracket kits available
- One or two different beam types per SLX™ module
- Very even light distribution
- Dimmable – perfect in snow, fog or similar conditions
- Compact, sealed and resistant to vibrations and shocks
- Available in 24VDC and 100-277VAC
- Proven endurance

The SLX™ Series LED searchlight module is made to replace conventional searchlight modules, increase light performance and eliminate costly and annoying maintenance. It is crafted to give superior value to the user with a powerful, compact and durable design, giving you the best return on investment possible.

The SLX™ searchlight unit will enable you detect an object at a distance of up to 2,600 meters away, depending on the chosen beam type for your needs.

The SLX™ is made to be mounted or fixed to suitable, existing movable platforms. Adapter bracket kits for certain movable searchlight platforms can also be delivered with your SLX™ searchlight module.

Our team are ready to take your requests and questions, so that your SLX™ searchlight can start making a real difference for you.

When safety at sea matters, Light Matters!

Input Specifications

Input voltage range

Alternative voltage rang

Frequency range

Current @ 24 VDC

Current @ 230 VAC

DIM

SLX™ Module

9-36 VDC

100-277 VAC (external PSU)

50-60 Hz

1,6A/3,2A

0,2A/0,4A

Not dimmable

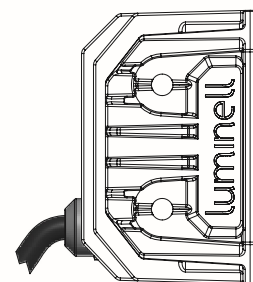

General Specifications

Startup time

Operating ambient temperature (Ta)

Storage temperature

Weight (apx.)

Weight external PSU (apx.)

Cable gland

Blind caps

IP class

Lifetime prediction (L70) @ Ta 25° C

Corrosion class

1 sec.

-40°C to +55°C

-40°C to +80°C

1,2kg

1x1kg or 1x2kg

Fixed and moulded 3m 2x1,5 cable

None

IP66/67

75.000 hrs

C5m ISO 9223/12944 (for offshore and maritime environments)

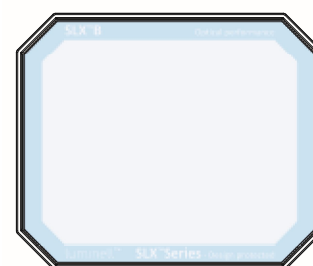

3,5° beam or 15° beam

Product	SLX B 40WDC1 5K	SLX B 80WDC1 5K
Model no.	L0525-1	L0525-2
Light beam angle	3.5°	15°
Total intensity Cd	400kCd	80kcd
Range (1 lux/0,25 lux)	630m / 1265m	280m / 565m
Color rendering (CRI)	70 (min.)	70 (min.)
Color temperature (CCT)	5000-6000K	5000-6000K
Power	40W	80W
Optional AC PSU Acc.	1xS0093 (max 2 SLX B/PSU)	1xS0093 (max 2 SLX B/PSU)
Comments:	1xS0117 (max 3 SLX B/PSU)	1xS0117 (max 3 SLX B/PSU)
	1x power input 1x PSU is needed for AC installations If the SLX is powered using an external VAC power supply the used power will increase by approx. 10%.	

Multiple mounting options for optional bracket

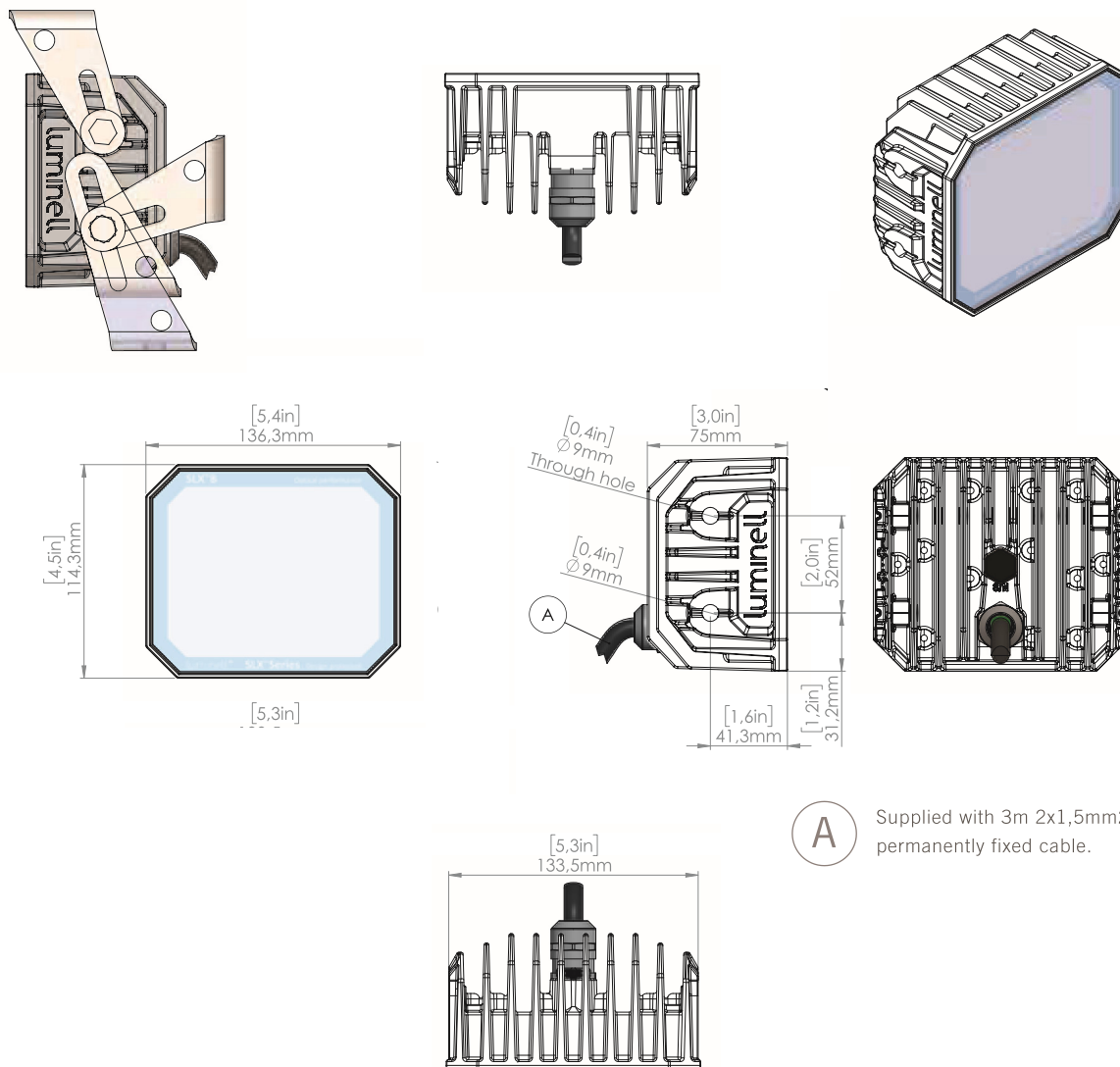

OPTINAL BRACKET: 1002613 L0570 B MARINE BRACKET SET	
Component:	Qty.
L0489 RLX B Bracket	1
S0023 M8x25 DIN 933 ISO 4017 A4 Hex Cap Screw	2
S0043 M8 DIN 985 ISO 7040 A4 Lock nut wNylon	2
insert S0185 8,4 DIN 9021 ISO 7093 A4 Flat washer	4

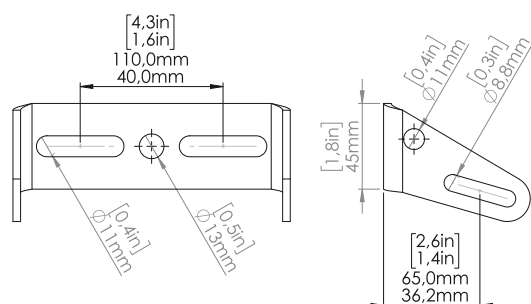

Input Specifications

Input voltage range

Alternative voltage range

Frequency range

Current @ 24 VDC

Current @ 230 VAC

DIM

SLX™ Module

22 – 30 VDC

100 – 277 VAC (external PSU)

50 – 60 Hz

< 6,25 A

< 0,7 A

0-100 kΩ or 0-10VDC

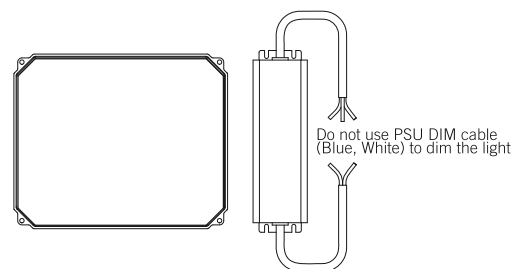

General Specifications

Startup time

Operating ambient temperature (Ta)

Storage temperature

Weight (apx.)

Weight external PSU (apx.)

Cable gland

Blind caps

IP class

Lifetime prediction (L70) @ Ta 25° C

Corrosion class

Cable lengths

1 sec.

- 40°C to + 55°C

- 40°C to + 80°C

5 kg

1 x 1 kg

2xM20 (6-13mm)

None

IP66/67

75.000 hrs

C5m ISO 9223/12944 (for offshore and maritime environments)

Recommended cable length between 24VDC PSU and SLX™ C is 20m (150W per section). Specified lengths are applicable with use of 2,5mm² cross section supply cable. This is a general recommendation. It is the installer's responsibility to assess this on each installation.

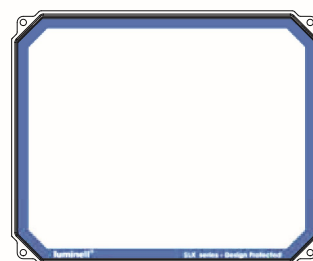

4° beam or 6+° beam

Product	SLX™ C 24V 4	SLX™ C 24V 6
Model no.	L0210-1	L0210-2
Light beam angle	4°	6+°
Total intensity Cd	875 000 Cd	875 000 Cd
Range (1 lux/0,25 lux)	935m / 1870m	935m / 1870m
Color rendering (CRI)	70 (min.)	70 (min.)
Color temperature (CCT)	5000-8000 Kelvin	5000-8000 Kelvin
Power	105 W	150 W
Optional AC PSU Acc.	1x S0093	1x S093
Comments:	<ul style="list-style-type: none"> - 1x power input - 1x PSU is needed for AC installations - If the SLX™ is powered using an external VAC power supply the used power will increase by approx. 10%. 	

Input Specifications

Input voltage range

Alternative voltage range

Frequency range

Current @ 24 VDC

Current @ 230 VAC

DIM

SLX™ Module

22 – 30 VDC

100 – 277 VAC (external PSU)

50 – 60 Hz

< 10,7 A

< 1,1 A

0-100 kΩ or 0-10VDC

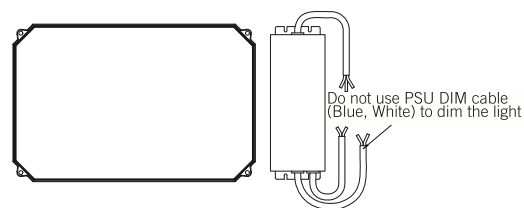

General Specifications

Startup time

Operating ambient temperature (Ta)

Storage temperature

Weight (apx.)

Weight external PSU (apx.)

Cable gland

Blind caps

IP class

Lifetime prediction (L70) @ Ta 25° C

Corrosion class

Cable lengths

1 sec.

- 40°C to + 55°C

- 40°C to + 80°C

8 kg

1 x 2 kg

2xM20 (6-13mm)

None

IP66/67

75.000 hrs

C5m ISO 9223/12944 (for offshore and maritime environments)

Recommended cable length between 24VDC PSU and SLX™ D is 15m (255W per section). Specified lengths are applicable with use of 2,5mm² cross section supply cable. This is a general recommendation. It is the installer's responsibility to assess this on each installation.

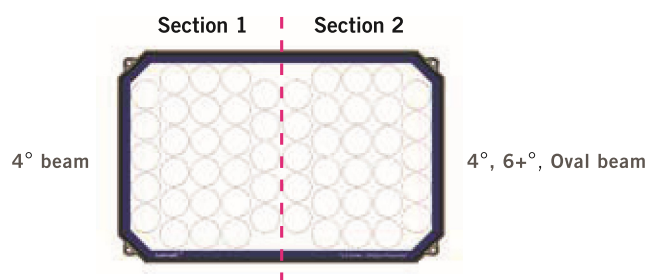

Product	SLX™ D 24V 4/4	SLX™ D 24V 4/6	SLX™ D 24V 4/Oval
Model no.	L0084-1	L0084-2	L0084-3
Light beam angle (Section 1/2)	4°/4°	4°/6+°	4°/Oval H
Total intensity Cd	1,75 mCd	1,75 mCd	0,950 mCd
Range (1 lux/0,25 lux)	1322m / 2645m	1322m / 2645m	975m / 1950m
Color rendering (CRI)	70 (min.)	70 (min.)	70 (min.)
Color temperature (CCT)	5000-8000 Kelvin	5000-8000 Kelvin	5000-8000 Kelvin
Power	210 W	255 W	255 W
Optional AC PSU Acc.	1x S0117	1x S0117	1x S0117
Comments:	- 2x sections linked together - 1x power input - 1x PSU is needed for AC installations		
	- 2x sections, each controlled separately. - 1x power input - 1x PSUs is need for AC installations - Control panel is highly recommended!		
	- If the SLX™ is powered using an external VAC power supply the used power will increase by approx. 10%.		

Materials

Body / casing / chassis	Seawater resistant; casted, anodized and powder coated aluminium
Glass	Tempered glass
Bracket, bolts, nuts, etc.	Stainless steel AISI 316L (1.4404), A4

Standards for SLX™ Searchlight

Description	Standard
LED modules for general lightning	EN 62031:2008/A1:2013/A2:2015
Photo biological safety of lamps and lamp systems	EN 62471:2008
EMC radiated and conducted	EN 55015:2013 and MIL-STD461F/G Navy Top Deck
EMC marine radiated and conducted (using screened cable)	EN/IEC 60945:2002
ETL / cETL certified	ANSI/UL1598, ANSI/UL1598A, ANSI/UL 8750 and CSA C22.2 No.250.0 (not SLX B)

Dimensions and Mounting

Front view

Side view

Side view up-close

SLX™ Searchlight (fixed)

Fig. 1

Fig. 2

Fig. 3

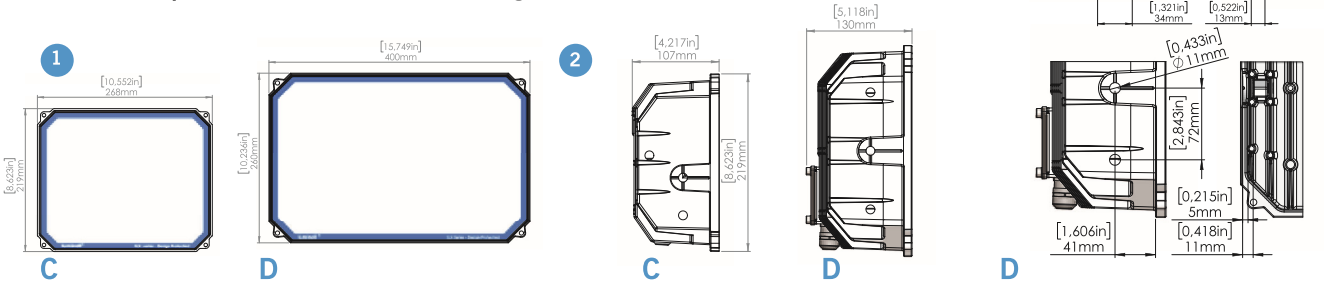

Bracket Options SLX™ D

L0413 Marine Bracket

L0378 Adapter Bracket D Type 1.

L0379 Adapter Bracket D Type 2.

L0412 C Marine Bracket Set

L0570 B Marine bracket set

Compatible with

SLX D

«Seematz» 351

«Norselight» SH 260-470, B-BH

SLX C

SLX B

Fig. 4

Fig. 5

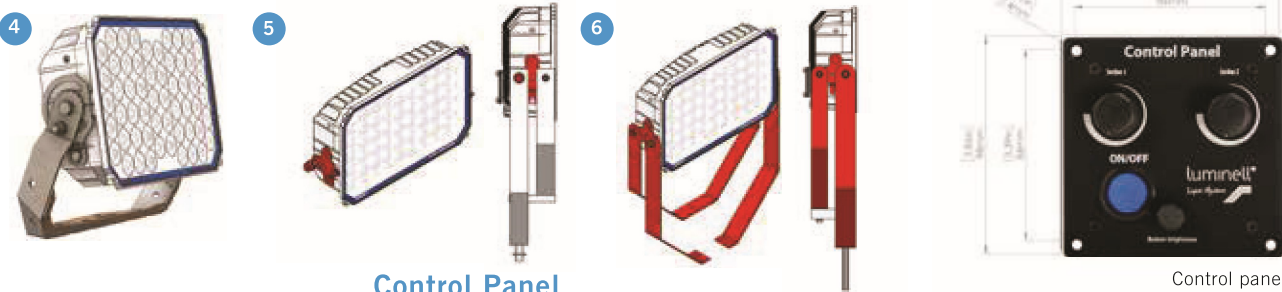

Control panel

Options and Accessories

- Control panel
- Protection grid
- Anti-ice kit
- Multiple searchlights can be controlled from the same panel
- Individual dimming of beams
- Master ON/OFF
- Dimmable panel light (require 24VDC/VAC)
- Select individual dimming range on beams (0-100% or 10-100%)
- Potential-free contact for optional control of external equipment
- Contact sets for optional external push button

Beam 3,5°



1lux@632m

Beam 15°



Beam 4°

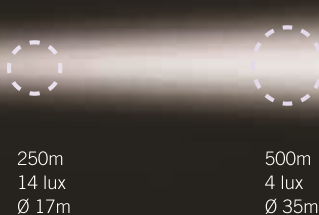

1lux@935m

Beam 6+°



1lux@935m

Beam 4°/4°



1lux@1323m

Beam 4°/6+°

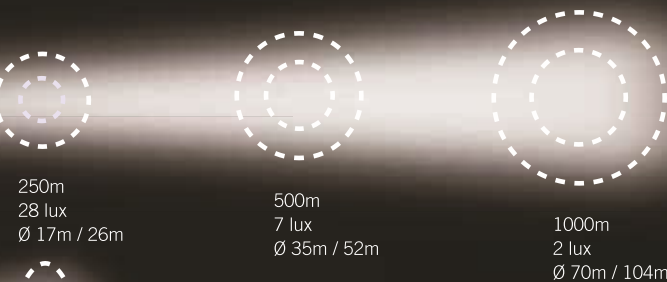

1lux@1323m

Beam 4°/Oval



1lux@1000m



Luminell SLX™ 220W LED searchlight

----- COMPARISON -----

Traditional 500W halogen searchlight

